

**3855 Northlake Blvd
Palm Beach Gardens, Florida**

PREFERRED



RETAIL BROKERAGE

NEW RETAIL ~ AVAILABLE FOR LEASE

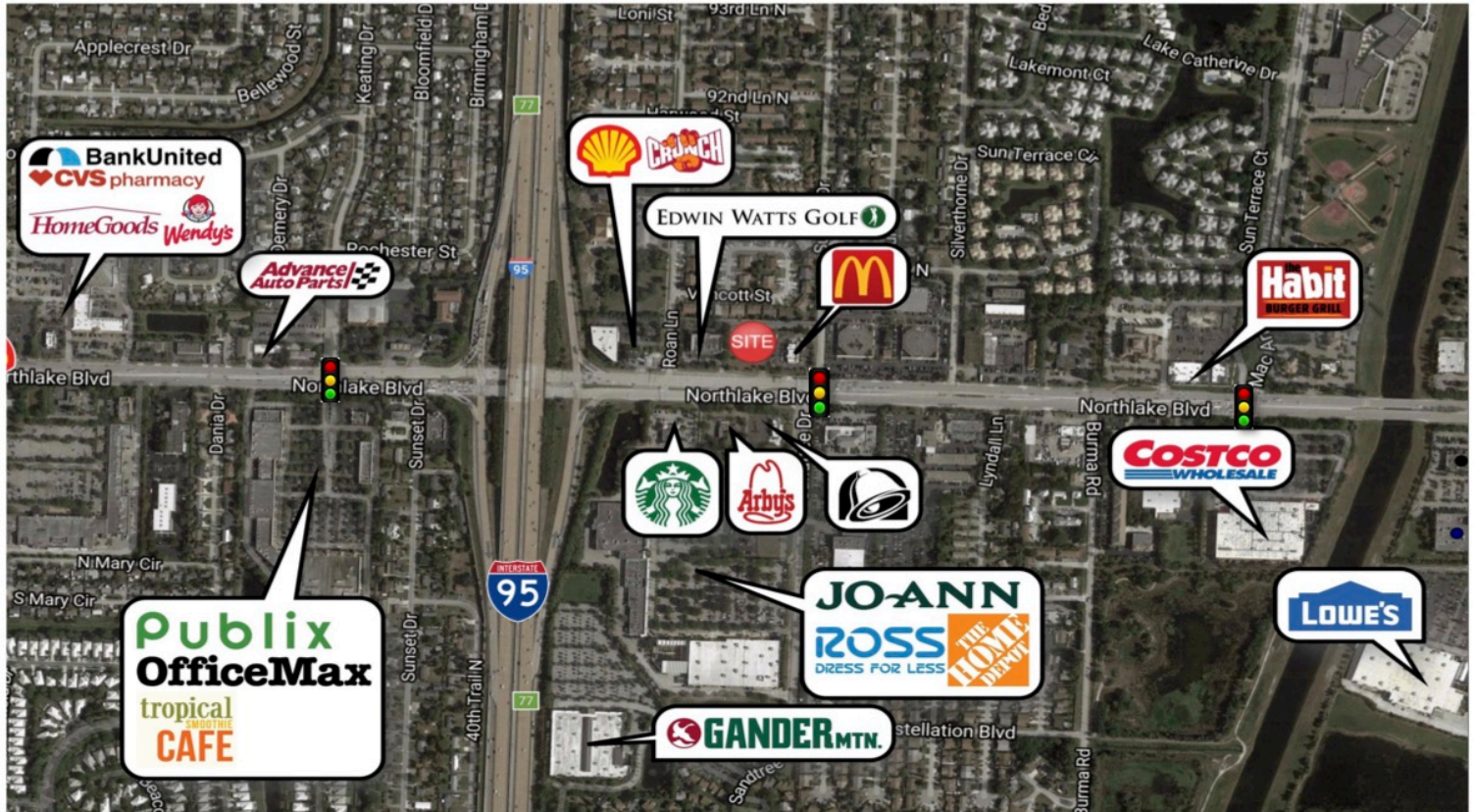

Proposed Site Plan

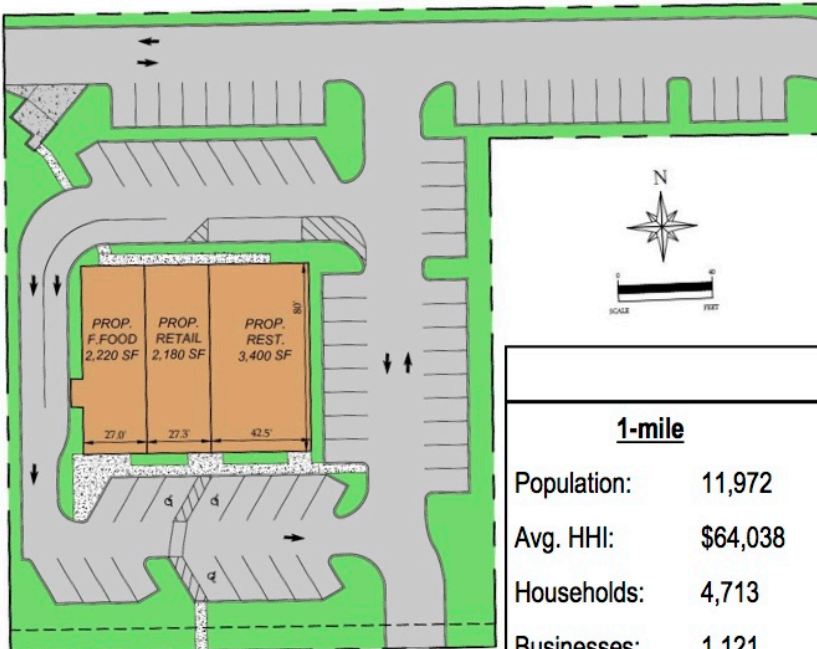

PROPERTY FEATURES

- * Approximately 7,800sf Available
- * Major Retail Corridor with over 52,000 VPD
- * Easy Access to Interstate 95 (172,000 VPD)
- * Excellent Visibility
- * Surrounded by national retailers and restaurants; such as Home Depot, Ross, Taco Bell, McDonald's, Costco, Lowe's, Publix, and many more!

DEMOGRAPHICS

	1-mile	3-mile	5-mile
Population:	11,972	90,536	168,179
Avg. HHI:	\$64,038	\$75,006	\$85,631
Households:	4,713	38,690	72,320
Businesses:	1,121	6,224	10,198

Brandon Woulfe ~ 561-325-6608 ~ Brandon@PreBrokers.com

Aerial Photos

